



# 5000i (3 Phase Supply)

What to specify...

1. Model

2. Voltage

3. Volume or Vacuum

4. Pre-filter

5. Main filter

6. Connection Kit

7. Power Lead

8. Interfacing Kit

	5000i			
	400V 3ph + N (Side Inlet)	400V 3ph + N (Rear Inlet)	220V 3ph (Side Inlet)	220V 3ph (Rear Inlet)
<b>1</b>				
<b>2</b>				
<b>3</b>				
<b>Voltage</b>	400V 3ph + N (Side Inlet)	400V 3ph + N (Rear Inlet)	220V 3ph (Side Inlet)	220V 3ph (Rear Inlet)
<b>Volume Control</b>	0LX5550D	0LX5549D	0LX5551D	0LX5565D
<b>Vacuum Control</b>	044250D	044261D	044251D	044265D
<b>Wattage</b>	7.5 kW	7.5 kW	7.5 kW	7.5 kW
<b>Frequency</b>	50Hz / 60 Hz	50Hz / 60 Hz	50Hz / 60 Hz	50Hz / 60 Hz
<b>Cabinet height (inc castors)</b>	1804 mm	1804 mm	1804 mm	1804 mm
<b>Cabinet width (not inc hose)</b>	1250 mm	1250 mm	1250 mm	1250 mm
<b>Cabinet depth (not inc hose)</b>	892 mm	892 mm	892 mm	892 mm
<b>Cabinet weight</b>	400 Kg	400 Kg	400 Kg	400 Kg
<b>Sound Rating (dBA)</b>	59	59	59	59
<b>Airflow m<sup>3</sup>/hr</b>	5000	5000	5000	5000
<b>Vacuum (kPa)</b>	12	12	12	12

**4 Pre-filter**



Side Inlet – One supplied  
Rear Inlet – One supplied and a pack of four pads  
See page 19-20

**5 Main Filter**



Two supplied - See page 21-22  
for your application

**6 Connection Hose Kit**

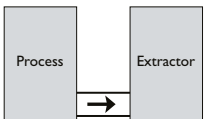

One supplied - See page 23-25  
to suit your system

**7 Power Cable**

5M Fixed power cable, no plug fitted.

**8 Machine Interfacing (Optional)**

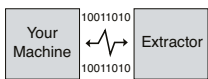

See page 27-29  
to match your system

Allows the Purex system to interface with a piece of equipment connected to it.

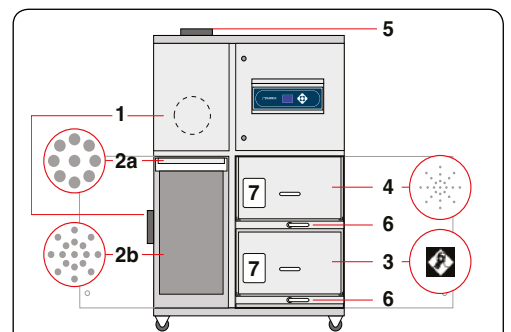

- Legend:**
- 1) Air inlet (Left or Rear) - 200mm safe seal.
  - 2) Pre-filter.
  - 3) Main Filter (HEPA location). †
  - 4) Main Filter (Carbon location). †
  - 5) Clean air returned to workplace.
  - 6) Filter locking handle.
  - 7) Filter identification label.
- Note:**
- 2a) Prefilter pad
  - 2b) Pleated Bag Filter
- Alternatively a Labyrinth filter can be supplied.

All machines are mounted on four castors for increased mobility.

† Standard Filter Only

## Digital Control System

A dedicated control, monitoring and display system unique to Purex fume extractors. All functions are fully automatic, all the user has to do is set the appropriate airflow on installation. The features of this system are designed to:

- Lower energy consumption by using variable speed motors and automatic flow control.
- Increase filter life by using the optimal extraction rate.
- Further protect people by constantly monitoring exhaust emissions.
- Interface with other equipment e.g. a laser.
- Maintain a constant extraction rate to prevent fume escape or damage to equipment.

## System Features...

- Automatic electronic flow control - maintains a constant extraction rate even as the filter blocks
- Adjustable airflow
- Clear and informative graphic display
- Gas and particle sensors on the exhaust
- Low capital and running costs
- Quick change patented Labyrinth pre-filters deliver longer filter life
- Submicron (HEPA) filtration removes 99.997% of particles down to 0.3 microns
- Activated carbon filtration removes harmful gas
- Simple to install and quiet in operation
- Easy to relocate and precision made from stainless steel
- High performance brushless motors

## Includes:

- 2 x Main filters and
- 1 x Labyrinth Pre-filter
- or 4 x Pre-filter pads with
- 1 x Pleated Bag Filter
- 1 x Power cable (no plug)

## Accessories

Please see the accessories brochure.